

# Type B3G Load Cell



## Short description

- Stainless steel IP67 "S" type load cell
- Tension and compression applications
- Suitable for hanging, hopper and other weighing devices
- Also available in imperial capacities and dimensions



test certificate no. D09-06.07  
C of C no R60/2000-CNI-06.02



Certificate no. 06-099A1

## Available models

Capacity	Accuracy	Full article description
50kg	C3	B3G-C3-50kg-6B
100kg	C3	B3G-C3-100kg-6B
250kg	C3	B3G-C3-250kg-6B
500kg	C3	B3G-C3-500kg-6B
1t	C3	B3G-C3-1t-6B
2.5t	C3	B3G-C3-2.5t-6B
5t	C3	B3G-C3-5t-6B
7.5t	C3	B3G-C3-7.5t-6B
10t	C3	B3G-C3-10t-6B

Specifications and dimensions are subject to change without notice and do not constitute any liability whatsoever.

# Type B3G Load Cell

## Detailed specifications B3G

Accuracy class		OIML R60 C3			
Output sensitivity ( = FS )	mV/V	3.0 ± 0.008			
Maximum capacity ( E <sub>max</sub> )	t	0.05, 0.1	0.25, 0.5, 1, 2.5	5, 7.5, 10	
Max.number of load cell intervals	n <sub>LC</sub>	3000			
Ratio of min. LC verification interval	$Y = E_{max} / v_{min}$	7000	10000	12000	
Combined Error	%FS	≤± 0.0200			
Minimum dead load	Of E <sub>max</sub>	0%			
Safe overload	of E <sub>max</sub>	150 %			
Ultimate overload	of E <sub>max</sub>	300 %			
Zero balance	of FS	< ± 1.0 %			
Excitation, recommended voltage	V	5 ~ 12			
Excitation maximum	V	18			
Input resistance	Ω	430 ± 50			
Output resistance	Ω	351 ± 2			
Insulation resistance	MΩ	≥5000 ( at 50VDC )			
Compensated temperature	°C	-10 ~ +40			
Operating temperature	°C	-35 ~ +65			
Storage temperature	°C	-40 ~ +70			
Element material		Stainless steel			
Ingress Protection (acc. to EN 60529)		IP67			
Recommended torque on fixation	Nm	M8:25	M12:75	M20:450	M24:750 M30:1450
ATEX classification (optional)		II1G Ex ia II1C T4	II1D Ex iaD 20 T73°C	II3G nL IIC T4	

## Wiring

### Wiring:

Shielded, 4 conductor cable.  
 Cable diameter: Ø5mm  
 Standard cable length: 6m  
 Shield not connected to element

### 4-wire diagram

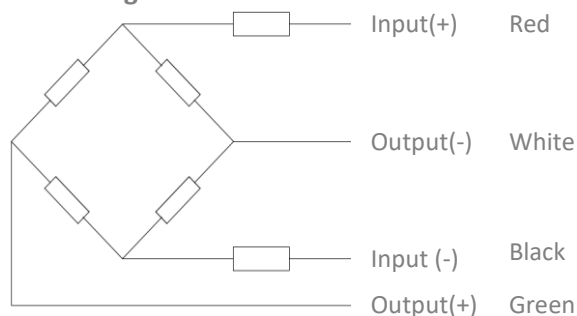

Specifications and dimensions are subject to change without notice and do not constitute any liability whatsoever.

# Type B3G Load Cell

Dimensions in mm

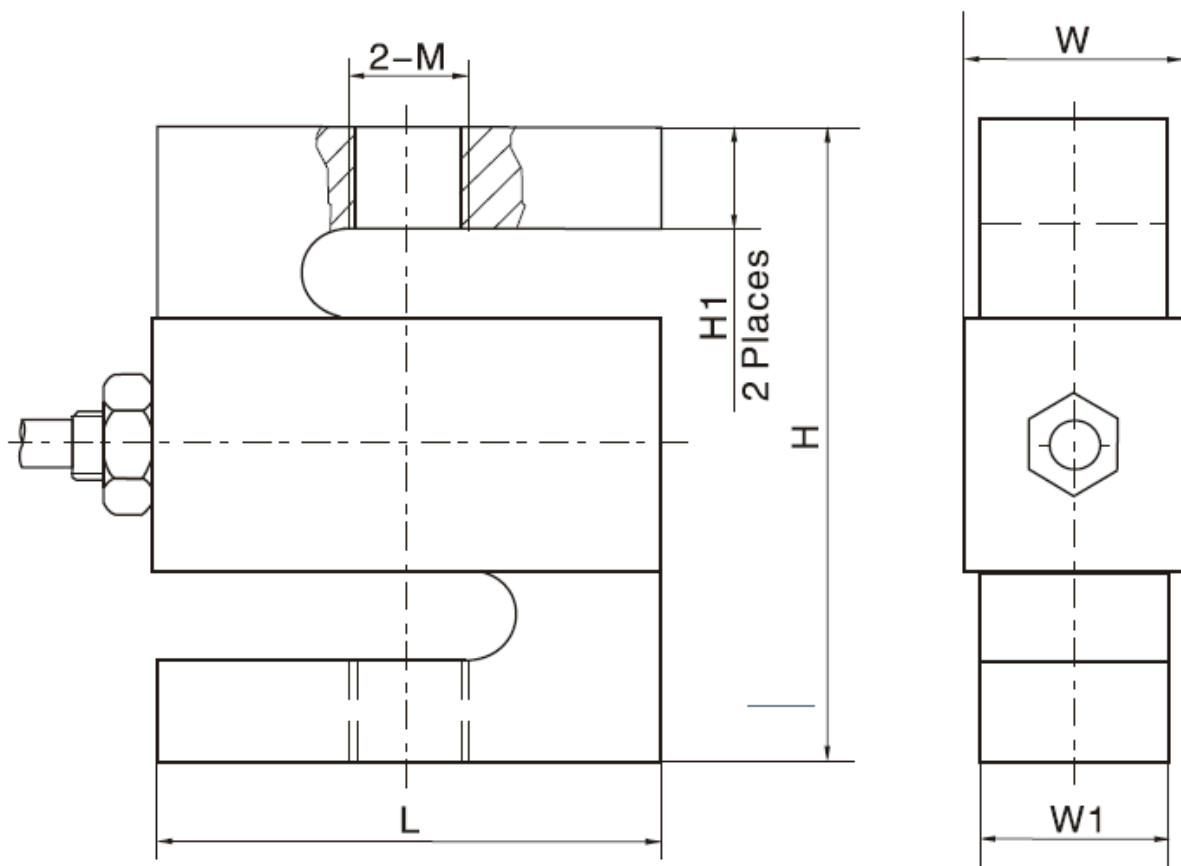

Dimension Capacity	L	H	H1	W1	W	M
50-100kg	50.8	60.96	8.89	11.68	15.06	M8
250-500kg	50.8	60.96	8.89	18.03	21.41	M12
1t	50.8	60.96	8.89	24.38	27.76	M12
2.5t	76.2	99.06	13.97	24.38	27.76	M20 x 1.5
5t	74.68	99.06	18.37	30.74	34.12	M20 x 1.5
7.5t	87.38	139.7	27.5	37.08	40.46	M24 x 2
10t	112.78	177.8	39.9	42.93	46.31	M30 x 2

Specifications and dimensions are subject to change without notice and do not constitute any liability whatsoever.

# Type B3G Load Cell

## Available accessories

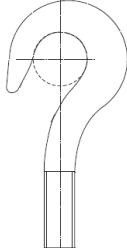
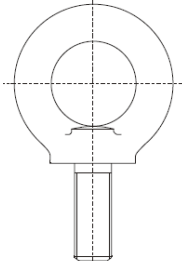
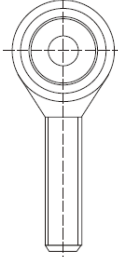
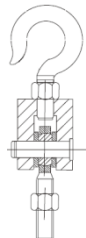
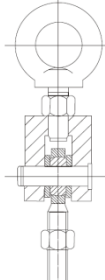
<p><b>HL-3-001-25kg-5t hook</b></p> <ul style="list-style-type: none"><li>• Alloy Steel</li><li>• Suitable for hybrid scales, crane scales, packaging scales and hopper scales</li></ul>	
<p><b>HL-3-002-25kg-5t eye</b></p> <ul style="list-style-type: none"><li>• Alloy Steel</li><li>• Suitable for hybrid scales, crane scales, packaging scales and hopper scales</li></ul>	
<p><b>HL-3-003-25kg-5t rod end</b></p> <ul style="list-style-type: none"><li>• Alloy Steel</li><li>• Suitable for hybrid scales, crane scales, packaging scales, hopper scales and other electronic weighing devices.</li></ul>	
<p><b>HL-3-004-25kg-5t hook assembly</b></p> <ul style="list-style-type: none"><li>• Alloy Steel</li><li>• Suitable for hybrid scales, crane scales, packaging scales, hopper scales and other electronic weighing devices.</li></ul>	
<p><b>HL-3-005-25kg-5t eye assembly</b></p> <ul style="list-style-type: none"><li>• Alloy Steel</li><li>• Suitable for hybrid scales, crane scales, packaging scales, hopper scales and other electronic weighing devices.</li></ul>	

## ΧΑΤΖΗΓΙΑΝΝΗΣ ΙΚΕ

Μακεδονίας 4, Αφίδνες, 19014  
τηλ: 22950 22696 fax: 22950 29816  
e-mail: info@gmh.gr  
www.gmh.gr

Specifications and dimensions are subject to change without notice and do not constitute any liability whatsoever.